

End Plate, Free Flow Plate, 03/01 Change Plate

50 to 100 ℓ /min
25MPa

Features

- ① The end plate is a modular valve plate used to close off a circuit that is not required, and when using a relief modular valve in a stand-alone configuration.
- ② The free flow plate is a modular valve plate is used in a one-way circuit that does not require a solenoid valve.
- ③ The 03/01 change plate makes it possible to use an 01 size modular valve with an 03 size sub-plate and base block.
- ④ The 06/04 change plate makes it possible to use an 04 size modular valve with an 06 size sub-plate and base block.

Specifications

Model No.	Nominal Diameter(Size)	Maximum Working Pressure MPa{kgf/cm ² }	Maximum Flow Rate ℓ /min	Weight kg
MOB-G01-10	1/8	25{255}	-	0.3
MOB-G01-H-10			-	0.6
MOB-G01-A-10 MOB-G01-B-10			50	0.6
MOB-G03-J50	3/8	25{255}	-	1.4
MOB-G03-H-50			-	2.5
MOB-G03-A-J50 MOB-G03-B-J50			100	1.3
MOB-G03-A-H-50 MOB-G03-B-H-50				2.3
MOB-G03-AA-J50			50	2.3
MOB-G06-AA-5411A	3/4	21{214}	200	8.0

Understanding Model Numbers

MOB - G 03 - A - (H) - J50

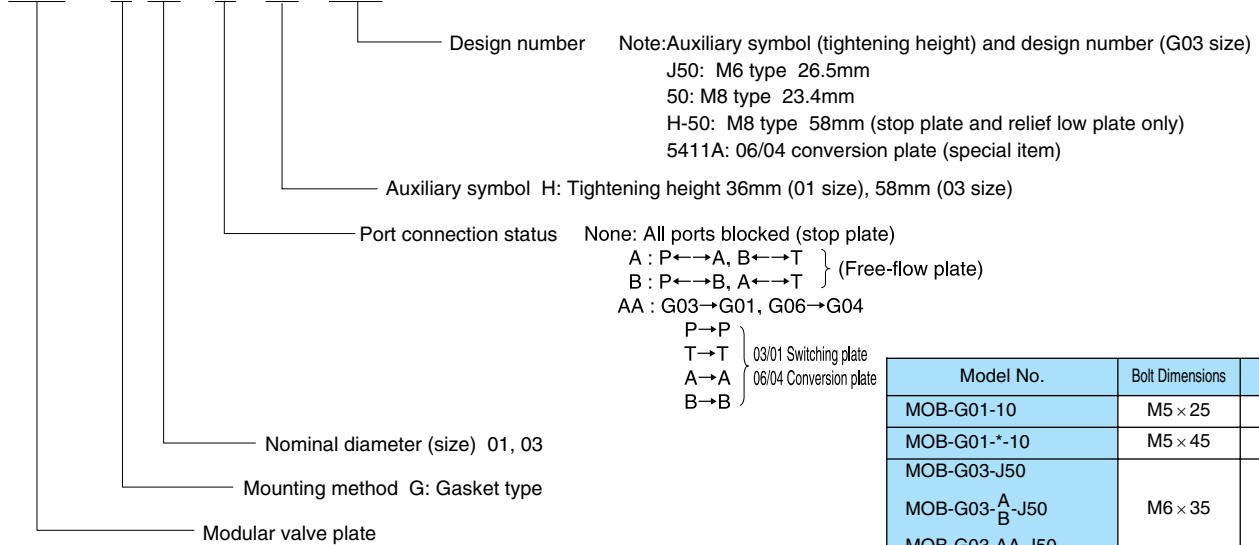

● Handling

- ① Installation bolts are not included. Use the table to the right to specify bolts for stand-alone use.

Model No.	Bolt Dimensions	Q'ty
MOB-G01-10	M5 × 25	4
MOB-G01-*-10	M5 × 45	4
MOB-G03-J50	M6 × 35	4
MOB-G03- _A / _B -J50		
MOB-G03-AA-50	M8 × 35	4
MOB-G03- _A / _B -50		
MOB-G03-H-50	M8 × 70	4
MOB-G03- _A / _B -H-50		
MOB-G06-AA-5411A	M12 × 70	6

Installation Dimension Drawings

MOB-G01-10

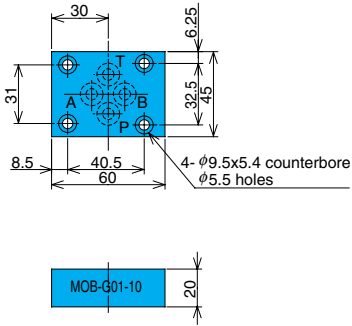

MOB-G01-H-10

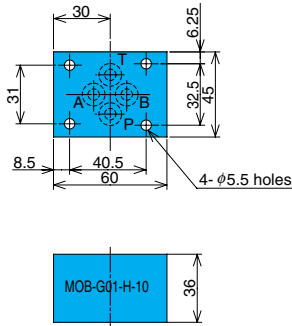

MOB-G01-A(B)-10

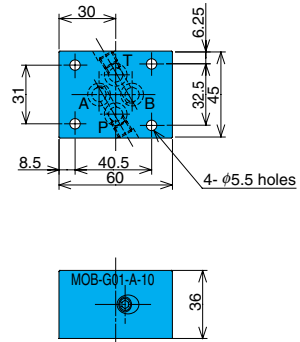

MOB-G03-J50

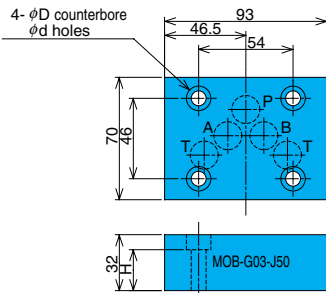

MOB-G03-H-50

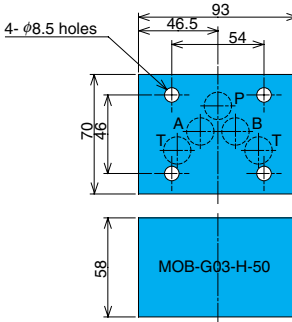

MOB-G03-A(B)-J50

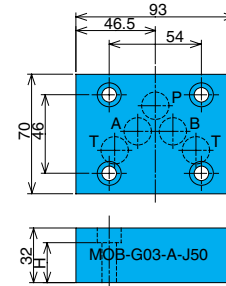

MOB-G03-A(B)-H-50

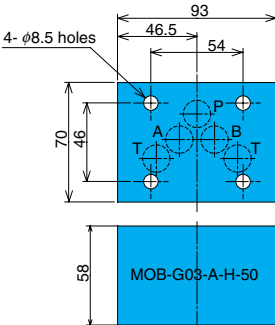

MOB-G03-AA-J50

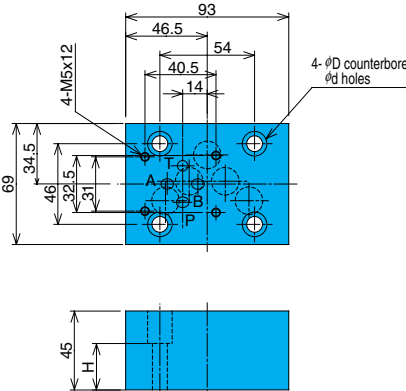

Model No.	D	H	d
MOB-G03-*-50	14	23.4	8.5
MOB-G03-*-J50	11	26.5	6.5

Seal Part List

Size	Part Name	Part Number	Q'ty
01	O-ring	1B-P9	4
03	O-ring	AS568-014(Hs90)	5
06	O-ring	1B-P28	4
	O-ring	1B-P20	2

Note) O-ring 1A/B-** refers to JIS B2401-1A/B.

Performance Curves

Hydraulic Operating Fluid Viscosity 32mm²/s

Pressure Loss Characteristics

MOB-G03-A-J50

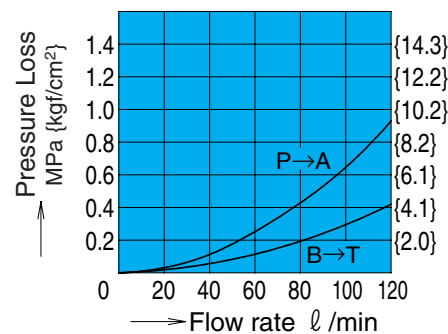

MOB-G06-AA-5411A

